

PLEASE READ BEFORE STARTING INSTALLATION

While MBRP Inc. has made every effort to ensure that all components of this system are of superior quality and properly packaged, it is the installer's responsibility to ensure the following before removal of the factory exhaust:

- that ALL components shown in the illustration on page 2 are present.
- that ALL mating components fit together.
- that there are no damaged components.
- that the system you have purchased is appropriate for your vehicle year, model and configuration.
- that the system will not interfere with any modifications previously installed.
- that you have read and understand these instructions.

If you have any questions or are uncertain about any aspect of the installation of this system to your vehicle please contact your dealer before commencing installation.

"Smokers™"

Installation Instructions for System; S8000409

2001-2006 Chev/GMC 2500/3500HD 6.6L Duramax

Please Note: For full installation you will require the appropriate Stacks Please check with you dealer for details.

Installing Your Front Section of MBRPinc. "Smokers™":

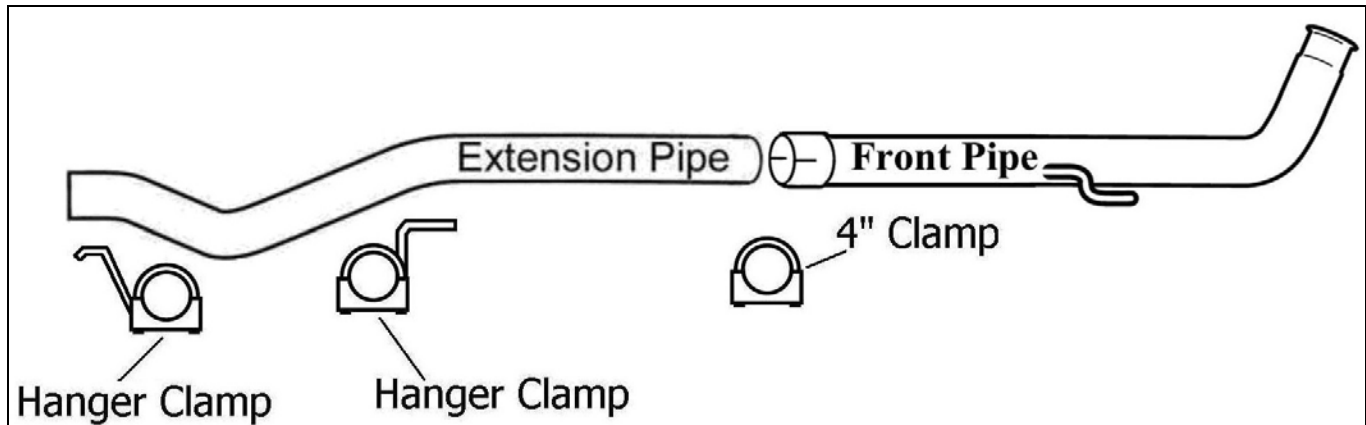

- 1 PC - Front Pipe
- 1 PC - Extension Pipe
- 3 PCS - 4" Clamp
- 3 PCS - Hanger Clamps

Removal of Stock System:

1. Apply a penetrating lubricant liberally to all exhaust fasteners, hangers and rubber insulators.
2. For 2001-2005 vehicles use a 15mm socket or wrench and disconnect the factory exhaust system at the four bolt flange located behind the catalytic converter. If the vehicle is not equipped with a catalytic converter disconnect the four bolt flange located approximately under the passenger side seat. For 2006 vehicles loosen the band clamp located behind the catalytic converter.
3. Remove the exhaust system from the rubber insulators and remove from under the vehicle. If a hoist is not available for use, it may be necessary to cut the tail pipe behind the muffler for removal of the system.
4. Unbolt the OEM hanger for the front pipe from the transmission and remove.
5. Loosen the factory band clamp and remove the stock front pipe. Some vehicles are not equipped with a catalytic converter. **Do not discard the band clamp as it is required for the installation.**

Installing Your Front Section of MBRPinc. "Smokers™":

1. Install the **Front Pipe** onto the factory down pipe using the band clamp removed previously. Do not fully tighten to allow for adjustment.
2. Install the hanger removed previously by sliding the outside hole in the rubber insulator over the hanger on the **Front Pipe** and re-connect to the transmission.
3. Connect the **Extension Pipe** to the **Front Pipe** at the slip joint placing the bend around, under the cross member. The **Extension Pipe** does not require cutting to fit Crew Cab trucks. For extended cab trucks, approximately 9½" needs to be cut off the end with the longest straight section of pipe.
4. Position the **Extension Pipe** as shown on the right and loosely install the **Hanger Clamp** with the shortest hanger. This will support the **Extension Pipe** during the installation of the rear section of the "Smokers™".



Installing Your Rear Section of MBRPinc. "Smokers™":

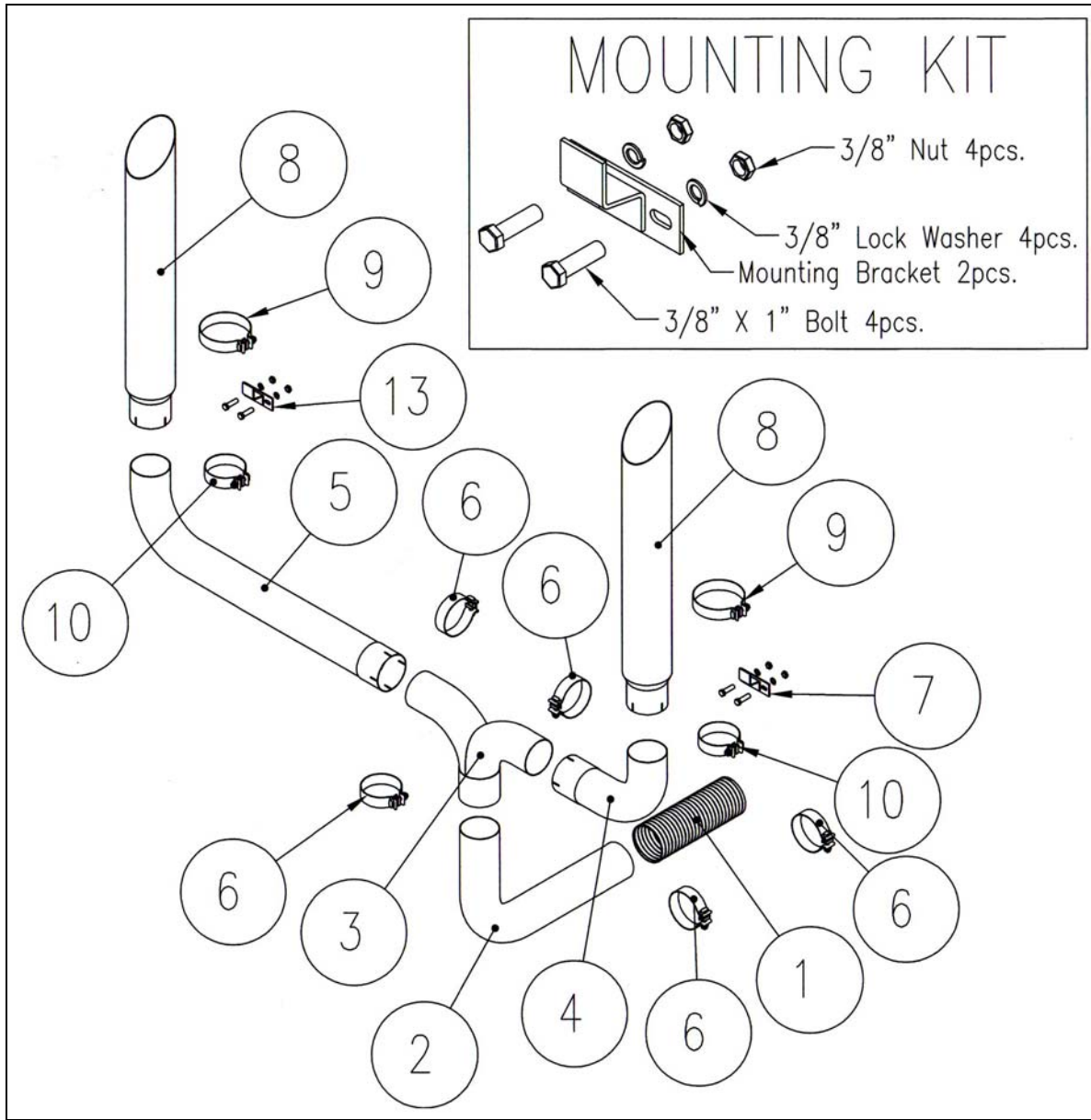

Included in this kit:

1.	Flex Pipe	1 pc.
2.	Elbow	1 pc.
3.	"T" Pipe	1 pc.
4.	Short 90	1 pc.
5.	Long 90	1 pc.
6.	4" Accuseal Clamp	5 pcs.
7.	Mounting Kit	

Included in the Stack kits:

8.	Stack (Purchased Separately)	2 pcs.
9.	Accuseal Clamp (Comes with Stack)	
10.	4" Accuseal Clamp (Comes with Stack)	



Figure 1



Figure 2



Figure 3



Figure 4



Figure 5

1. Loosely assemble the in bed portion of the **“T” Pipe** assembly. Some models may require trimming of the **“T” Pipe** in order to accommodate the width of the truck bed and the stacks that have been purchased. Be sure to place the clamps over the pieces before they are assembled.

2. Place the **Stacks** onto the **“T” Pipe** assembly and place into the desired position in the truck bed. The **“Long 90”** should be on the driver side so that the **“T” Pipe** passes through the bed floor on the passenger side. Refer to Figure 1.

3. Place the **Mounting Brackets** between the **Stacks** and the front of the truck bed so that the **Stacks** are properly spaced from the front of the truck bed. Center the **Mounting Bracket** on the **Stack** and mark the front of the truck bed in the center of the slotted holes in the **Mounting Brackets**. Center punch the marks and drill holes to accommodate a **3/8” Bolt**. Refer to figure 2.

4. Loosely attach the **Mounting Brackets** to the front of the truck bed using the **3/8” hardware** supplied. Set the **Stacks** up in the bed and loosely attach them to the **Mounting Brackets**. Make sure the **Stacks** are in the desired position and the **“T” Pipe** assembly is level.

5. Mark the bed floor where the **“T” Pipe** is resting. MBRPinc. recommends tracing around where the **“T” Pipe** meets the bed floor. Refer to figure 2. Remove the **Stacks** and **“T” Pipe** assembly from the bed of the truck. Find the center of the circle traced onto the bed floor, mark and center punch it. Go under the vehicle and locate the center punch mark. This marks the location where you are going to cut a hole for the **“T” Pipe** to pass through the bed of the truck. If you cannot find the center punch mark measure to it in the bed and transfer these measurements under the vehicle. Make sure that there is clearance for the **Elbow** to pass by any frame cross members. Remove or modify any heat shields that there is any interference shields that there is any interference with.

6. Cut a hole through the truck bed providing adequate clearance around the part of the **“T” Pipe** that passes through the truck bed. MBRPinc. recommends using a **5” diameter hole saw**. It may be required to cut part of a bed rail away.

7. Set the **“T” Pipe** assembly at the desired height from the floor of the bed (This will set the height of the **Stacks**). Using spacers to hold the **“T” Pipe** at the desired height, loosely attach the **Stacks** to the **Mounting Brackets** making sure that they are straight. This will hold the assembly steady while you line the system up to the exhaust under the vehicle. Refer to figure 5.



Figure 6

8. Measure from the **“T” Pipe** slip joint to the exhaust system that you are connecting to. Mark and cut the shorter side of the **Elbow** to the required length so that it lines up with the front part of the exhaust system. Refer to figure 6.
9. Loosely install the **Elbow** into the **“T” Pipe**. Measure and mark the **Elbow**, **Extension Pipe** and **Flex Pipe** so that you will end up with the longest section of **Flex Pipe** possible. Cut the pieces to the required lengths.
10. Attach the **Elbow** to the **“T” Pipe** slip joint and then attach the **Flex Pipe** to both the **Elbow** and the front part of the exhaust system. Be sure to slide the required **Clamps** over the **Elbow** and **Flex Pipe** before connecting it to the vehicle’s exhaust system.
11. Make sure that the **Mounting Brackets** are centered on the **Stacks** and tighten the fasteners holding the **Mounting Brackets** to the front of the truck bed. Tighten all the **Clamps** making sure that the *“Smokers”™* remains properly aligned.
12. Install remaining clamps around pipes where required. Check along the whole length of the exhaust system to ensure that there is adequate clearance around the fuel and brake lines or any wiring. If any interference is detected relocate or adjust.



Shown with 5” X 36” Angle Cut Stacks (B1530)

Congratulations! You are ready to begin enjoying the improved performance and driving experience of your MBRP Inc. *“Smokers”™*. We hope you enjoy your purchase.