

S8204409

FORD 6.4L FILTER BACK SMOKERS™
SINGLE CC SB & LB

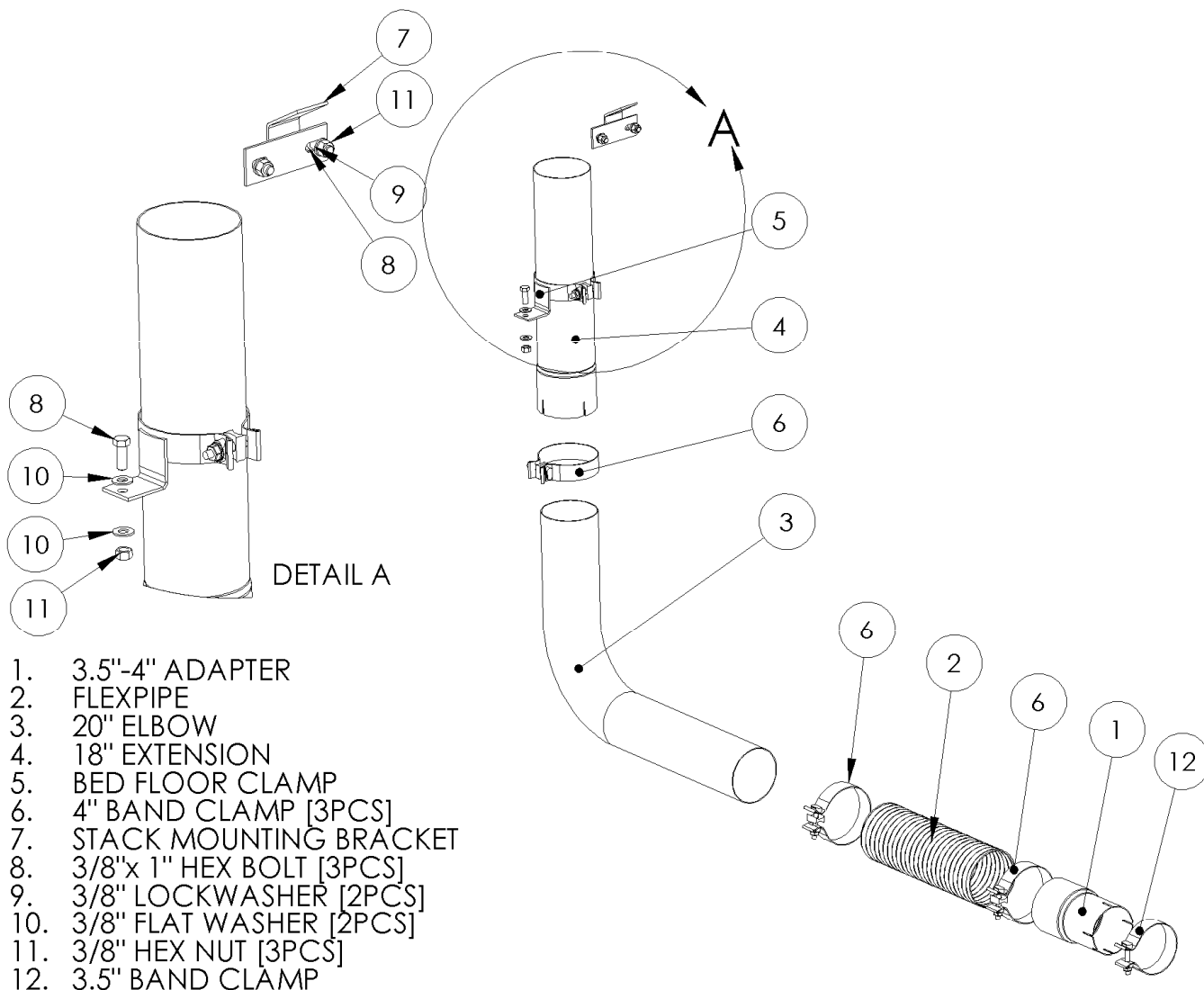

- 1. 3.5"-4" ADAPTER
- 2. FLEXPipe
- 3. 20" ELBOW
- 4. 18" EXTENSION
- 5. BED FLOOR CLAMP
- 6. 4" BAND CLAMP [3PCS]
- 7. STACK MOUNTING BRACKET
- 8. 3/8"x 1" HEX BOLT [3PCS]
- 9. 3/8" LOCKWASHER [2PCS]
- 10. 3/8" FLAT WASHER [2PCS]
- 11. 3/8" HEX NUT [3PCS]
- 12. 3.5" BAND CLAMP

PLEASE READ BEFORE STARTING INSTALATION

While MBRP Inc. has made every effort to ensure that all components of this system are of superior quality and properly packaged it is the installer's responsibility to ensure the following before removal of the factory exhaust:

- that ALL components shown above are present.
- that ALL mating components fit together.
- that there are no damaged components.
- that the system you have purchased is appropriate for your vehicle year, model and configuration.
- that the system will not interfere with any modifications previously installed or planned.
- that you have read and understand these instructions.

If you have any questions or are uncertain about any aspect of the installation of this system to your vehicle please contact your dealer before commencing installation.

Removal of Stock System



Figure 1

1. Apply a penetrating lubricant liberally to all exhaust fasteners, hangers and rubber insulators.
2. Loosen the nut on the band clamp located behind the Diesel Particulate Filter [DPF].
3. Remove the muffler and tail pipe from the OEM rubber hangers. If a hoist is being used the system can be removed in one piece by removing the passenger side bottom shock bolt and swinging the shock out of the way. Separate the stock exhaust system at the slip joint located behind the DPF. Remove the muffler and tail pipe from under the truck.
Be sure to re-install the bottom shock bolt. If a hoist is not being used you will have to cut the tail pipe at the over axle section, behind the muffler and remove the exhaust in two pieces. **See Figure 1.**

Installation of MBRPinc. "Smokers™"

1. Measure 20" across from the inside surface of the passenger side bed rail. Mark this location. This will be the centerline of the stack once installed. **See Figure 2.**

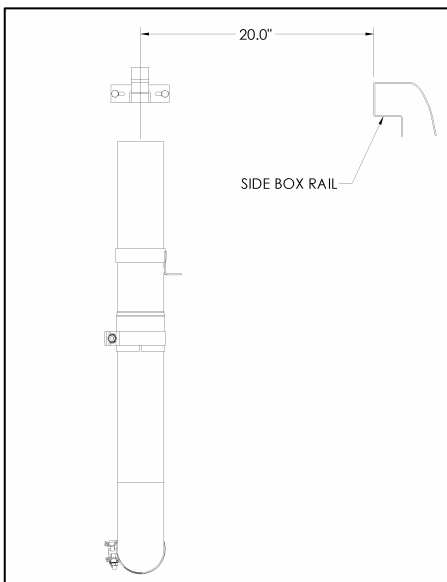

Figure 2



Figure 3

2. Place the **Stack Mounting Bracket** centered on the mark you made in step 1. Mark the bolt hole location of the **Stack Mounting Bracket** onto the front rail of the bed. Center punch the marks and drill holes to accommodate **3/8"** hardware.
See Figure 3.



Figure 4

3. Loosely attach the **Stack Mounting Bracket** to the front of the truck bed using the **3/8"** hardware supplied. Set the stack up in the bed and loosely attach it to the **Stack Mounting Bracket**. Make sure the stack is vertical and in the desired position. **See Figure 4.**



Figure 5

4. Mark the bed floor where the stack is resting. This is where the **Extension Pipe** will pass through the floor. Remove the stack from the bed of the truck. Find the center of the circle traced onto the bed floor, mark and center punch it. Drill the hole using a **5"** hole saw. It may be required to cut part of a bed floor rail away. **See Figures 5 and 6.**



Figure 6



Figure 7

5. Install the **3.5"-4"** **Adapter** with a **3.5"** **Band Clamp** over the outlet of the DPF. Pay attention to the alignment of the notch in the **3.5"-4"** **Adapter** and the pin located on the outlet of the DPF. Ensure that the **Adapter** is fully seated. **See Figure 7.**



6. Install the **Flexpipe** onto the outlet of the **3.5"-4" Adapter**. Place the **20" Elbow** in position and mark the locations to cut. Allow 3" of overlap at the **Flexpipe** and **20" Elbow** connections. Cut the **20" Elbow** to the required length and install. Remember to slide the required **Band Clamps** onto the parts before assembly. **See Figure 8.**

Figure 8

7. Slide the **Bed Floor Clamp** onto the **Extension Pipe**. Install the assembly on the outlet of the **20" Elbow** with the required **4" Band Clamp**. Reinstall the Stack by sliding the inlet over the **Extension Pipe** then securing the Stack to the **Mounting Bracket** with the clamp supplied with your Stack. Align the system and tighten all Clamps to ensure your "Smokers™" exhaust system remains properly aligned.

8. Slide the **Bed Floor Clamp** to the desired position on the **Extension Pipe** to allow installation of the mounting hardware. Ensure the Stack is aligned vertical. Mark the the mounting hole from the bracket to the bed floor and drill a hole to accommodate the **3/8"** hardware supplied. Secure the **Bed Floor Clamp** to the truck and tighten the clamp to the **Extension Pipe**. This clamp will ensure the Stack remains in position and doesn't vibrate.

9. Check along the whole length of the exhaust system to ensure that there is adequate clearance around fuel lines, brake lines and any wiring. If any interference is detected relocate or adjust.



Shown with 6" X 36" Stack (B1610)

Congratulations! You are ready to begin enjoying the improved performance and driving experience of your MBRP Inc. "Smokers™". We hope you enjoy your purchase.